

CIRCULAR SHUT-OFF DAMPER

RCE - INOX

The **RCE** type damper is a type damper is a shut-off circular damper (airtightness class 4C according to EN1751) in 316 L stainless steel. It is suitable for clean rooms applications (laboratories, operation rooms, semi-conductors ...).



CODIFICATION

RC ———> **RC Range** - Circular damper

X ———> **E** - Class 4 airtightness

CONSTRUCTION

Casing
Stainless steel 316 L
EPDM lip seal on the shutter to ensure upstream/downstream airtightness class 4 according to EN 1751
Male air connection with EPDM lip seal to ensure frame's airtightness class C according to EN 1751.

Blade
Stainless steel 316 L

COMMANDES

Control manual/suitable for actuator (8 mm square shaft)	Motorized damper
	Electrical actuator

PERFORMANCES

	RCE
Upsteam/downstream airtightness (EN 1751)	Class 4
Frame's airtightness (EN 1751)	Class C
Acceptable pressure	1000 Pa
Acceptable air velocity max.	12 m/s
Operating temperatures	From -20°C to +70°C
Atex	Zone : 1; 2; 22 Temperature class : T6

CIRCULAR SHUT-OFF DAMPER

RCE - INOX

DIMENSIONS AND RECOMMENDED TORQUES

Ø (mm)	L (mm)	Weight manual (kg)	Torque (Nm)
100	200	1.00	4
125	200	1.10	4
160	200	1.30	4
200	200	1.50	4
250	200	2.10	4
315	300	3.70	4
355	300	4.20	4
400	300	6.10	5
450	400	8.10	5
500	400	9.30	8
560	400	10.80	8
630	400	12.70	10

RCE manual / suitable for actuator

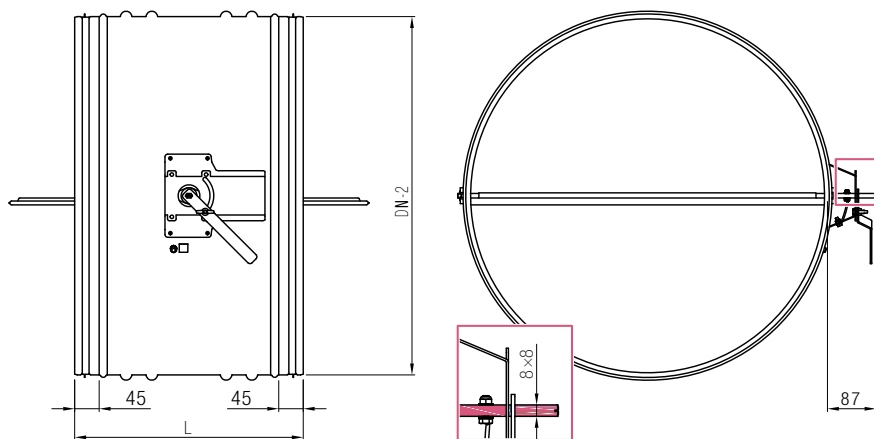

Dimensions in mm