

CIRCULAR VOLUME CONTROL DAMPER

RCO

RCO damper is a circular volume control damper in galvanized steel. RCO is designed to adjust the volume of airflow in ventilation networks for commercial HVAC applications. The **RCO** control damper is manual or motorized (see the control table)



CODIFICATION

RC ———> **RC range** - Circular damper



X ———> **0** - Not classified

CONSTRUCTION

Casing
Galvanized steel <i>option : stainless steel 304 L or 316 L</i>
Seals ensuring good airtightness with the ductwork
Casing's airtightness class C according to EN 1751

Blade
Circular plate in galvanized steel <i>option : stainless steel 304 L or 316 L</i>

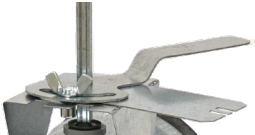
CONTROL

manual/motorized control (Control shaft 8 mm square)	Motorized damper
	

PERFORMANCES

	RCO
Downstream airtightness (EN 1751)	Not classified
Frame's airtightness (EN 1751)	Class C
Acceptable pressure	500 Pa
Acceptable velocity	12 m/s
Operating temperatures	from -20°C to +80°C

CIRCULAR VOLUME CONTROL DAMPER

RCO

DIMENSIONS AND RECOMMENDED TORQUES

Ø (mm)	L (mm)	I (mm)	Weight manual RCO (kg)	Torque (Nm)
80*	100	35	0,4	2
100	100	35	0,4	2
125	100	35	0,5	2
160	100	35	0,6	2
200	100	35	0,8	2
250	100	55	1	4
315	120	55	1,5	4
355	120	85	1,7	8
400	150	85	2,2	8
500	150	85	9,9	10
560	180	85	3,7	15
630	180	85	4,3	15

*Only galvanized steel

RCO manual

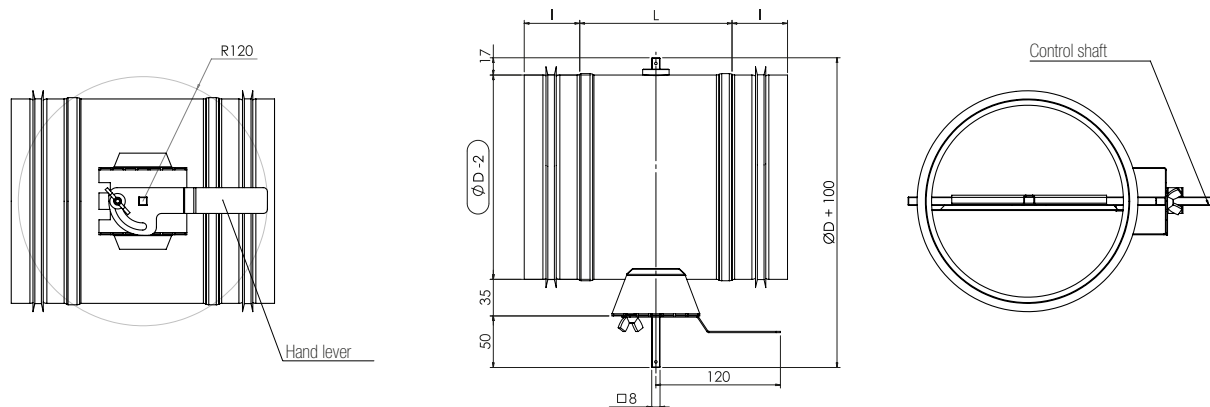

FT RCO_10/2023_EN information and data can not be considered as contractual. Design and data changes may occur without notice during F2A's continuous product development.